

Change description

See CI 9968

Document Release Status

RELEASED

Release Date
2006-12-12

Version
1

TOOTHED WASHER

Internal tooth
Type ITB
Steel
Electroplated based on zinc-nickel, black
As per ELV directive

1 Requirements

1.1 Material

Steel 1770-03 STD 1117,7.Hardened and tempered, Hardness 410-490 HV30

1.2 Surface treatment

Treated ZnNi black passivated Y200-3 color black VCS 5737,29

1.3 Others

The number of teeth, the length of the teeth and the thickness of the washer over the teeth shall be optional with the manufacturer with provision, however, that the projection of the teeth on both sides of the washer must be uniform within a tolerance equal to one half of the projection on one side. The washers must be symmetrically shaped.

Free from burrs, sharp edges and other defects which may lessen the usability.

Symbols, designations and general drawing methods VCS 5023,509.

Part must comply with restricted substance management standard: WSS-M99P9999-A1 to help safeguard health, safety and the environment.

The copying, distribution and utilization of this document as well as the communication of its contents to others without expressed authorization is prohibited. Offenders will be held liable for payment of damages. All rights reserved in the event of the grant of a patent, utility model or ornamental design registration.

Document Name
TOOTHED WASHER

Document Type
MULTI-PART DRAWING

FMC Part No

Volvo Car Corporation

Document No	Revision	Volume No	Page No (In this doc.)
01054915	002	01	1 (2)

1.4 Dimensions

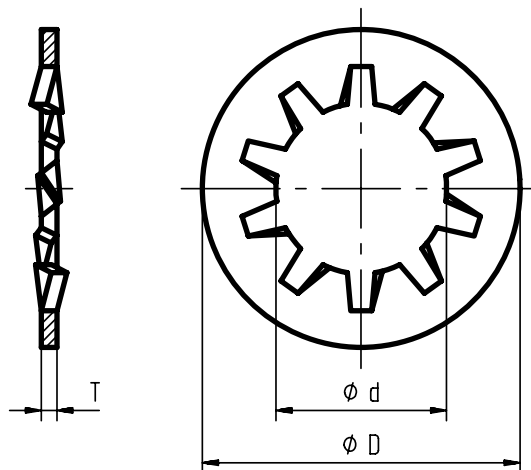

d	D	T	Screw diameter		Part No.	
			Metric	Inch		
H13	h14					
3,2	6	0,4	M3	1/8	No. 5	986672
3,7	7	0,5	(M3)	-	No. 6	986673
4,3	8	0,5	M4	5/32	No. 8	986674
5,1	9	0,5	M5	3/16	No. 10	986675
5,3	10	0,6	-	7/32	No. 12	986676
6,4	11	0,7	M6	-		986677
6,5	12,1	0,6	-	1/4		986678
8,2	14	0,8	M8	5/16		986679
9,9	17,4	0,9	-	3/8		986680
10,5	18	0,9	M10	-		986681
11,6	19,8	0,9	M11	7/16		986682
12,5	20,5	1	M12	-		986683
13,2	22	1	-	1/2		986684
14,5	24	1	(M14)	9/16		986685
17	26	1,2	M16	5/8		986686
21	33	1,4	M20	-		986687
23	36	1,5	M22	7/8		986688

2 Information

This standard agrees with German Standard DIN 6797 Form J August 1971 except for $d = 6,5, 9,9, 11,6, 13,2, 20$ and 26 mm.

VOLVO

Volvo Car Corporation

Document Name

TOOTHED WASHER

Document Type

MULTI-PART DRAWING

Document No

01054915

Revision

002

Volume No

01

Page No (In this doc.)

2 (2)